

Community Modal bazar Drainage Layout Plan

PROJECT : Nature Based Adaptation towards Prosperous and Adept Lives & Livelihoods in Bangladesh (NABAPALLAB)	FUNDED BY	TECHNICAL SUPPORTED BY	DRAWING TITLE:	DRAWN BY: Sayeduz Zaman Senior Officer– CI & RES CARE-Bangladesh, Khulna	REVIEW BY: MD. ZAHIRUL ISLAM Regional Manager – CI & RES CARE-Bangladesh, Khulna	APPROVED BY:	SHEET NO :
			Drainage System Layout Plan	SIGNATURE :	SIGNATURE :	SIGNATURE :	REVISION :
							SCALE = NTS
							DATE :

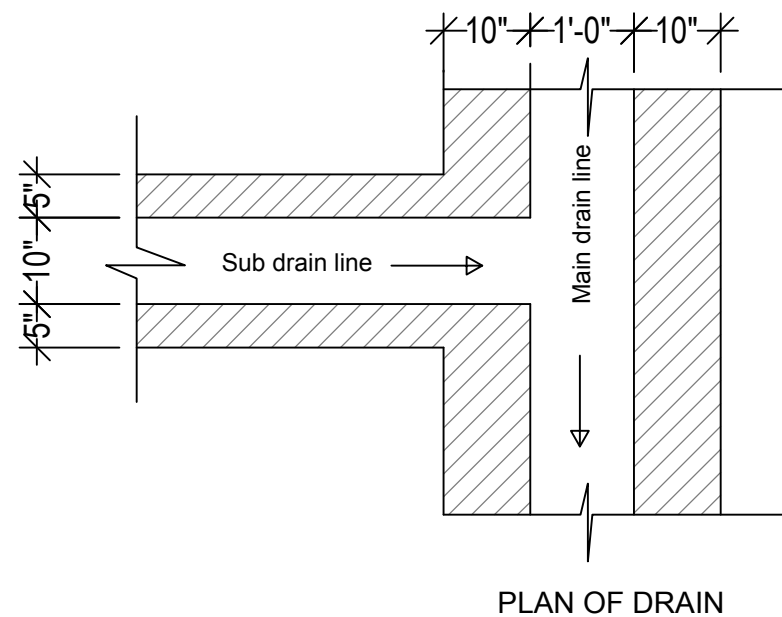

SPECIFICATION:

1. Casting Ratio -

- Cement : Sand : Aggregate - 1:2:4
(Use Stone Chips as coars aggregate)

2. Brick Work Ratio:

- Cement : Sand - 1:4 for 125 mm B/W
- Cement : Sand - 1:6 for 250 mm B/W

3. Plaster Work - Cement: Sand (1:5)

4. Main drain Slab Reinforcement (length 5 ft)

- Short Direction - 10 mm dia 125mm C/C
- Long Direction 175 mm C/C

5. Sub drain Slab Reinforcement (length 5 ft)

- Short Direction - 10 mm dia 175mm C/C
- Long Direction 200 mm C/C

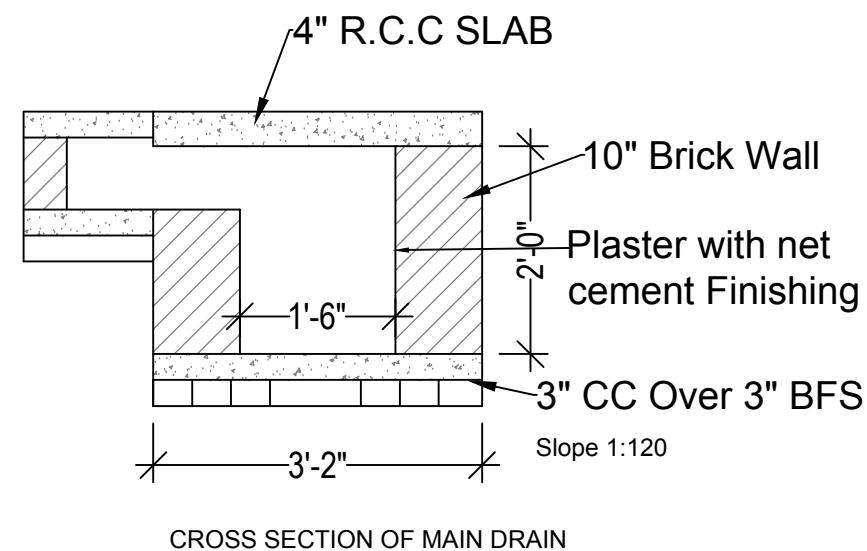
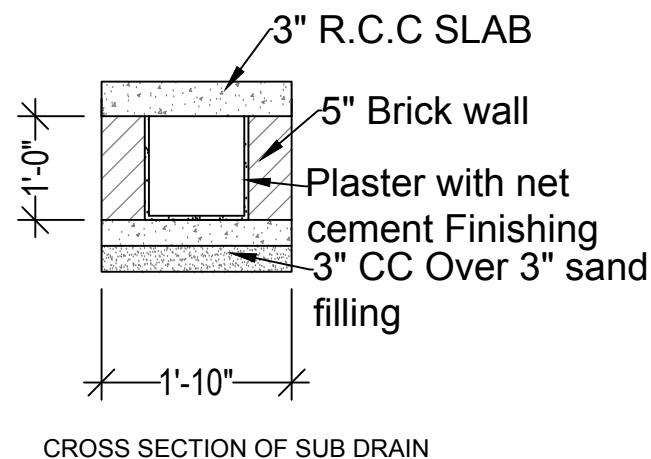

PROJECT : Nature Based Adaptation towards Prosperous and Adept Lives & Livelihoods in Bangladesh (NABAPALLAB)	FUNDED BY	TECHNICAL SUPPORTED BY	DRAWING TITLE:	DRAWN BY: Sayeduz Zaman Senior Officer- CI & RES CARE-Bangladesh, Khulna	REVIEW BY: MD. ZAHIRUL ISLAM Regional Manager - CI & RES CARE-Bangladesh, Khulna	APPROVED BY:	SHEET NO :
			Drainage System Plan & section	SIGNATURE :	SIGNATURE :	SIGNATURE :	REVISION :
							SCALE = NTS
							DATE :